



## STAY AMONG THE INFLUENTIAL, BE A PART OF THE INFLUENCE

From the birth of a nation to the next chapters of history, the Potomac River has been a single constant, writing the story of D.C., breathing life into the resurgence and influence of The Wharf, and bringing together movements and cultures of the world.

InterContinental® Washington D.C. – The Wharf features 278 luxury guestrooms with 25 executive and presidential suites, uniquely inspired by the neighborhood to showcase a distinctive blend of contemporary style, classic sophistication, and sustainable design.

Offering over 17,000 square feet of meeting space, the hotel features 11 function spaces with floor-to-ceiling windows showcasing stunning waterfront views of the Potomac River.

With a state-of-the-art fitness center, a rooftop pool to take in the D.C. skyline, as well as a 4,250 square foot spa, guests have a myriad of ways to revel in relaxation before they take on the world.

### SIGNATURE RESTAURANTS & BARS

**Restaurant**, American Cuisine, water views and patio

**The Watering Hole**, sit riverside with a view paired with a glass of wine or beer (weather dependent).

**Waves Rooftop Deck**, if you prefer poolside relaxation, dine on light fare and mixologist-fashioned craft cocktails (Seasonal).



INTERCONTINENTAL  
WASHINGTON D.C. – THE WHARF

## MEET AT THE SOURCE OF GLOBAL SUCCESS

D.C. is a city of influence, of global change, and of future-shapers. And InterContinental® Washington D.C. – The Wharf, allows you to host memorable meetings and events of any size and authority.

With over 17,000 square feet of event space, choose from 11 unique meeting rooms, and multiple elegant ballrooms to serve as your business' headquarters while in D.C. Find inspiration with an abundance of natural light and waterfront views in addition to all of the impeccable hospitality, services and amenities needed to execute a successful event.

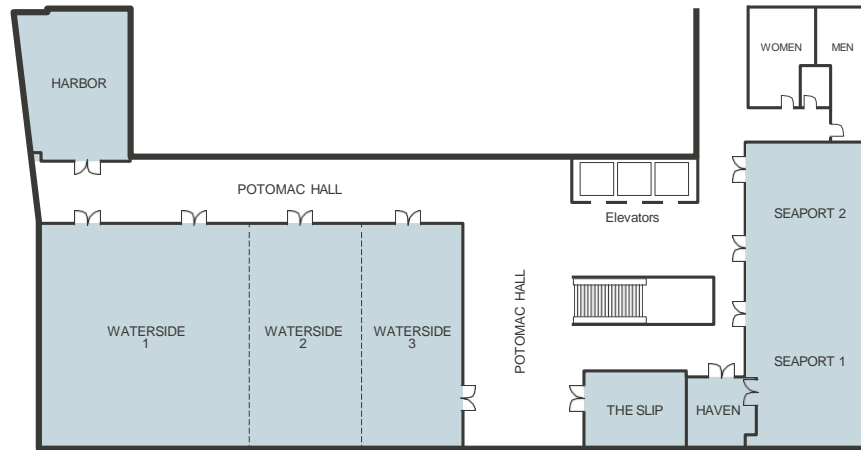

2ND FLOOR MEETING ROOMS

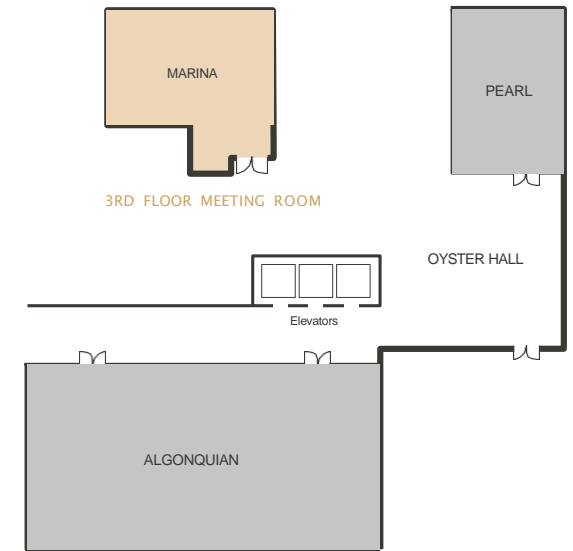

12TH FLOOR MEETING ROOMS

Name of Room	Theatre Style	Classroom	Cocktail Reception	Banquet	Conference	Hollow Rectangle	Size(sq ft)	Size(sq m)	Length(ft)	Width(ft)	Height(ft)	Floor
<b>Waterside (Combined)</b>	660	288	630	400	96	120	5,304	492.8	102	52	18	2
<b>Waterside 1</b>	291	144	261	200	48	72	2,704	251.2	52	52	18	2
<b>Waterside 2</b>	140	72	140	80	42	54	1,196	111.1	52	28	18	2
<b>Waterside 3</b>	162	72	150	100	42	54	1,404	130.4	52	27	18	2
<b>The Slip</b>	N/A	N/A	N/A	N/A	14	N/A	419	38.9	24	17	10	2
<b>Haven</b>	24	N/A	15	10	12	N/A	245	22.8	17	14	10	2
<b>Harbor</b>	83	39	80	40	24	30	817	75.9	32	25	10	2
<b>Seaport (Combined)</b>	220	108	150	120	66	72	1,988	184.7	71	28	10	2
<b>Seaport 1</b>	120	54	80	60	30	42	890	82.7	32	28	10	2
<b>Seaport 2</b>	108	45	80	60	30	36	1,098	102.0	39	28	10	2
<b>Potomac Hall</b>	N/A	N/A	N/A	N/A	N/A	N/A	3,672	341.1	N/A	N/A	N/A	2
<b>Marina</b>	78	32	60	40	24	30	740	68.7	31	28	10	3
<b>Pearl</b>	60	36	50	40	18	24	584	54.3	27	23	11	12
<b>Oyster Hall</b>	N/A	N/A	N/A	N/A	N/A	N/A	904	84.0	N/A	N/A	N/A	12
<b>Algonquian</b>	280	120	200	170	60	78	2,255	209.5	72	31	11	12

\*Please note the capacities above are without audio visual set up

801 Wharf St SW, Washington, District of Co  
 For additional information and bookings,  
 please visit [InterContinentalWharfDC.com](http://InterContinentalWharfDC.com) or call 202.627.6994